

QUITO PARK PLAYGROUND INSTALLATION PROJECT



OWNER
PLEASANT VALLEY RECREATION AND PARK DISTRICT
 1605 EAST BURNLEY ST. CAMARILLO CA. 93010

COVER SHEET

PROJECT
QUITO PARK PLAYGROUND INSTALLATION

REVISIONS		
NO.	REVISIONS/ISSUE	DATE
1	DESCRIPTION	DATE

ISSUED FOR: BID	DATE OCT. .202
DRAWN / CHECKED	
SCALE N.T.S.	PROJECT NO. QUITO-PG-25
SHEET	

L-1

GENERAL NOTES

- ALL WORK SHALL CONFORM TO THE 'GREENBOOK,' 'STANDARD SPECIFICATIONS AND PLANS FOR PUBLIC WORKS CONSTRUCTION' IN EFFECT AS OF THE DATE OF THESE PLANS.
- CONSTRUCTION PERMITS SHALL BE PAID FOR BY THE DISTRICT.
- PLAY EQUIPMENT TO BE INSTALLED AND INSPECTED BY CERTIFIED PLAYGROUND INSTALLER; INSTALLER TO PROVIDE DISTRICT OF EQUIPMENTS CONFORMANCE TO PLAYGROUND SAFETY STANDARDS IN FORCE DURING PROJECT INSTALLATION.
- UPON CONTRACT EXECUTION, CONTRACTOR TO PROVIDE DISTRICT WITH A CRITICAL PATH SCHEDULE TO INCLUDE EACH ITEM, LEAD TIME, ORDER AND INSTALLATION DATE FOR SUBSTANTIAL COMPLETION.
- PROVIDE FOR POSITIVE DRAINAGE. NOTIFY DISTRICT CONTACT IF SITE CONDITIONS ARE OTHERWISE. MAINTAIN EXISTING FLOWLINES AND DRAINAGE PATTERNS.
- VERIFY AND STAKE LOCATION OF UTILITIES PRIOR TO CONSTRUCTION AND AS REQUIRED BY GOVERNING AGENCIES. CONTRACTOR IS LIABLE FOR DAMAGES TO EXISTING UTILITIES INCURRED BY PROJECT WORK.
- REPAIR AND REPLACE ANY EXISTING IMPROVEMENTS DAMAGED DURING CONSTRUCTION TO PRE-CONSTRUCTION CONDITION TO DISTRICT'S SATISFACTION.
- CHECK DIMENSIONS AND SITE CONDITIONS BEFORE STARTING WORK. ANY DISCREPANCIES OR POSSIBLE DEFICIENCIES BETWEEN DRAWINGS AND SPECIFICATIONS WITH FIELD CONDITIONS SHALL BE BROUGHT TO THE DISTRICT'S IMMEDIATE ATTENTION.
- VERIFY PROPERTY LINES PRIOR TO COMMENCING WORK. NO CONSTRUCTION ITEM, INCLUDING FOOTINGS, SHALL EXTEND BEYOND PROPERTY LINE.
- MATERIALS AND WORKMANSHIP, CONFORM TO LATEST CALIFORNIA BUILDING CODES AND APPLICABLE GOVERNING AGENCY CODES AND ORDINANCES. NO PART OF CONTRACT DOCUMENTS TO BE IN VIOLATION OF CODES. IF DISCREPANCIES EXIST, NOTIFY DISTRICT.
- CONSTRUCTION AND INSTALLATION OF ALL LANDSCAPE ITEMS SHALL BE ACCORDING TO STATE, COUNTY AND LOCAL CODES, ORDINANCES AND UP TO CAL-OSHA SAFETY ORDERS REGARDING PERFORMANCE OF WORK.
- EXCAVATION IN THE VICINITY OF UNDERGROUND UTILITIES SHALL PROCEED WITH CARE AND, IF NECESSARY, BY HAND THE CONTRACTOR BEARS FULL RESPONSIBILITY FOR THIS WORK AND THE DISRUPTION OR DAMAGE TO UTILITIES SHALL BE IMMEDIATELY REPAIRED AT NO EXPENSE TO THE DISTRICT.

GENERAL NOTES II

- THE CONTRACTOR SHALL LAYOUT AND VERIFY ALL DIMENSIONS PRIOR TO ORDERING PLAY EQUIPMENT AND CONSTRUCTION. ANY DISCREPANCIES SHALL BE BROUGHT TO THE DISTRICT'S ATTENTION FOR RESOLUTION PRIOR TO ORDERING EQUIPMENT AND COMMENCING ANY FURTHER WORK.
- CONTRACTOR SHALL BE RESPONSIBLE FOR ANY COORDINATION WITH SUB-CONTRACTORS REQUIRED TO ACCOMPLISH THE WORK.
- PIPING, FOOTINGS, AND SLEEVES SHALL BE SET IN PRIOR TO INSTALLATION OF CONSTRUCTION ITEMS.
- THE DRAWINGS AND SPECIFICATIONS REPRESENT FINISH STRUCTURES, CONSTRUCTION MEANS AND METHODS, SAFETY PROCEDURES, BRACING, TEMPORARY SUPPORTS, AND SHORING WILL BE THE SOLE RESPONSIBILITY OF THE CONTRACTOR. OBSERVATION VISITS TO THE JOB SITE BY THE DISTRICT CONTACT DOES NOT INCLUDE INSPECTION OF CONSTRUCTION METHODS AND SAFETY CONDITIONS AT WORK SITE. THESE VISITS SHALL NOT BE CONSTRUED AS CONTINUOUS AND DETAILED INSPECTIONS.
- GIVE DISTRICT CONTACT A MINIMUM OF 48 HOURS NOTICE FOR REQUIRED OR REQUESTED JOB SITE VISIT.
- FOR SUBMITTALS, SAMPLES AND SHOP DRAWINGS REQUESTED, SUBMIT VIA EMAIL TO DISTRICT CONTACT.
- PROPOSED GRADES SHALL MEET EXISTING GRADES WITH SMOOTH AND CONTINUOUS TRANSITION, FLUSH ALONG ENTIRE EDGE.

GRADING NOTES

- PRIOR TO CONSTRUCTION, VERIFY EXISTING AND PROPOSED GRADES, UTILITY LOCATIONS, EXISTING DRAINAGE STRUCTURES,
- NOTIFY THE DISTRICT CONTACT IMMEDIATELY UPON DISCREPANCIES BETWEEN THESE PLANS AND EXISTING CONDITIONS.
- GRADE PLANTING AREAS ACCORDING TO CONSTRUCTION PLAN AWAY FROM HARDSCAPE AND PROPERTY LINES.
- FINISH GRADES IN PLANTING AREAS TO BE FLUSH WITH ADJACENT PAVING SURFACE.
- DO NOT PROCEED WITH CONSTRUCTION AS DESIGNED WHEN OBSTRUCTIONS, AREA DISCREPANCIES, OR GRADE DESIGN ARE DISCOVERED. SUCH CONDITION SHALL BE IMMEDIATELY BROUGHT TO THE DISTRICT CONTACT'S ATTENTION. CONTRACTOR ASSUMES FULL RESPONSIBILITY FOR NECESSARY REVISIONS DUE TO FAILURE TO GIVE SUCH NOTIFICATION.

STORM WATER POLLUTION NOTES

- ERODED SEDIMENTS AND OTHER POLLUTANTS MUST BE RETAINED ON SITE AND MAY NOT BE TRANSPORTED FROM THE SITE VIA SHEETFLOW, SWALES, AREA DRAINS, NATURAL DRAINAGE COURSES, OR WIND.
- STOCKPILES OF EARTH AND OTHER CONSTRUCTION-RELATED MATERIALS MUST BE PROTECTED FROM BEING TRANSPORTED FROM THE SITE BY THE FORCES OF WIND OR WATER.
- FUELS, OILS, SOLVENTS, AND OTHER TOXIC MATERIALS MUST BE STORED IN ACCORDANCE WITH THEIR LISTING AND ARE NOT TO CONTAMINATE THE SOIL AND SURFACE WATERS. ALL APPROVED STORAGE CONTAINERS ARE TO BE PROTECTED FROM THE WEATHER. SPILLS MUST BE CLEANED UP IMMEDIATELY AND DISPOSED OF IN A PROPER MANNER. SPILLS MAY NOT BE WASHED INTO THE DRAINAGE SYSTEM.
- EXCESS OR WASTE CONCRETE MAY NOT BE WASHED INTO THE PUBLIC WAY OR ANY OTHER DRAINAGE SYSTEM. PROVISIONS SHALL BE MADE TO RETAIN CONCRETE WASTES ON SITE UNTIL THEY CAN BE DISPOSED OF AS SOLID WASTE.
- TRASH AND CONSTRUCTION-RELATED SOLID WASTES MUST BE DEPOSITED INTO A COVERED RECEPTACLE TO PREVENT CONTAMINATION OF RAINWATER AND DISPERSAL BY WIND.
- SEDIMENTS AND OTHER MATERIALS MAY NOT BE TRACKED FROM THE SITE BY VEHICLE TRAFFIC. THE CONSTRUCTION ENTRANCE ROADWAYS MUST BE STABILIZED SO AS TO INHIBIT SEDIMENTS FROM BEING DEPOSITED INTO THE PUBLIC WAY. ACCIDENTAL DEPOSITION MUST BE SWEEPED UP IMMEDIATELY AND MAY NOT BE WASHED DOWN BY RAIN OR OTHER MEANS.
- ANY SLOPES WITH DISTURBED SOILS OR DENUDED VEGETATION MUST BE STABILIZED SO AS TO INHIBIT EROSION BY WIND AND WATER.
- THE FOLLOWING BMPs AS OUTLINED IN, BUT NOT LIMITED TO, THE CALIFORNIA STORMWATER BEST MANAGEMENT PRACTICE HANDBOOK, CALIFORNIA STORMWATER QUALITY ASSOCIATION (CASQA), 2003, OR THE LATEST REVISED EDITION, MAY APPLY DURING THE CONSTRUCTION OF THIS PROJECT (ADDITIONAL MEASURES MAY BE REQUIRED IF DEEMED APPROPRIATE BY CITY INSPECTORS):

- | | |
|--|--------------------------------------|
| ECO1 - SCHEDULING | SE07 - STREET SWEEPING AND VACUUMING |
| NS01 - WATER CONSERVATION PRACTICES | WE01 - WIND EROSION CONTROL |
| NS03 - PAVING AND GRINDING OPERATIONS | WM01 - MATERIAL DELIVERY AND STORAGE |
| NS06 - ILLICIT CONNECTION/DISCHARGE | WM02 - MATERIAL USE |
| NS08 - VEHICLE AND EQUIPMENT CLEANING | WM03 - STOCKPILE MANAGEMENT |
| NS09 - VEHICLE AND EQUIPMENT FUELING | WM04 - SPILL PREVENTION AND CONTROL |
| NS10 - VEHICLE AND EQUIPMENT MAINTENANCE | WM05 - SOLID WASTE MANAGEMENT |
| NS12 - CONCRETE CURING | WM06 - HAZARDOUS WASTE MANAGEMENT |
| NS13 - CONCRETE FINISHING | WM08 - CONCRETE WASTE MANAGEMENT |
| SE-6 - GRAVEL SANDBAGS | |

PROJECT DESCRIPTION

PROJECT IS WITHIN EXISTING PARK AND INCLUDES REMOVAL OF PLAY EQUIPMENT, RUBBER SURFACING, ENGINEERED WOOD FIBER (EWF) AND SAND. INSTALLATION OF PLAYGROUND EQUIPMENT, ENGINEERED WOOD FIBER (EWF) RUBBER POUR-IN-PLACE (PIP) SURFACING AND SUB-SURFACE DRAINAGE PITS. FEES FOR PERMITS TO BE PAID BY THE DISTRICT. CONTRACTOR RESPONSIBLE FOR PROCESSING AND COORDINATING PERMITS WITH THE CITY OF CAMARILLO.

SHEET INDEX

- L-1 COVER SHEET
- L-2 CONSTRUCTION DETAILS
- L-3 PLAYGROUND LAYOUT OPTION 1
- L-4!!!!!!PLAYGROUND LAYOUT OPTION 2
- L-5!!!!!!DRAINAGE LAYOUT PLAYGROUND OPTION 1
- L-6!!!!!!DRAINAGE LAYOUT PLAYGROUND OPTION 2

UTILITIES

(CONTRACTOR SHALL CALL DIG ALERT AND NOTIFY ANY AGENCIES OR UTILITIES 48 HOURS PRIOR TO STARTING CONSTRUCTION OR EXCAVATION. LIST BELOW FOR REFERENCE ONLY. CONTRACTOR IS RESPONSIBLE FOR VERIFYING LOCATIONS AND PROTECTING ALL UTILITIES.)

SOUTHERN CALIFORNIA EDISON
 3589 FOOTHILL DRIVE
 THOUSAND OAKS, CALIFORNIA
 (800)855-4555

SO CAL. GAS COMPANY
 130 PATTERSON,
 SANTA BARBARA, CALIFORNIA
 HANK MORALES
 (800)427-2200

WATER AND WASTEWATER
 CAMROSA WATER DISTRICT
 SANTA ROSA RD
 CAMARILLO CA 9301293012
 (805) 388-0226226

VERIZON
 (800)483-4000

TIME WARNER CABLE
 (888)892-2253

DISTRICT CONTACTS

PARK SERVICES MANAGER
 MATTHEW PARKER
 1605 EAST BURNLEY STREET
 CAMARILLO CA. 93010
 (805)495-6471



Know what's below.
Call 811 before you dig.
DIG ALERT

IMPORTANT NOTE:
 NO EXCAVATION OF ANY KIND IS TO OCCUR ANYWHERE ON SITE WITHOUT FIRST VERIFYING THE LOCATIONS OF EXISTING UNDERGROUND UTILITIES.

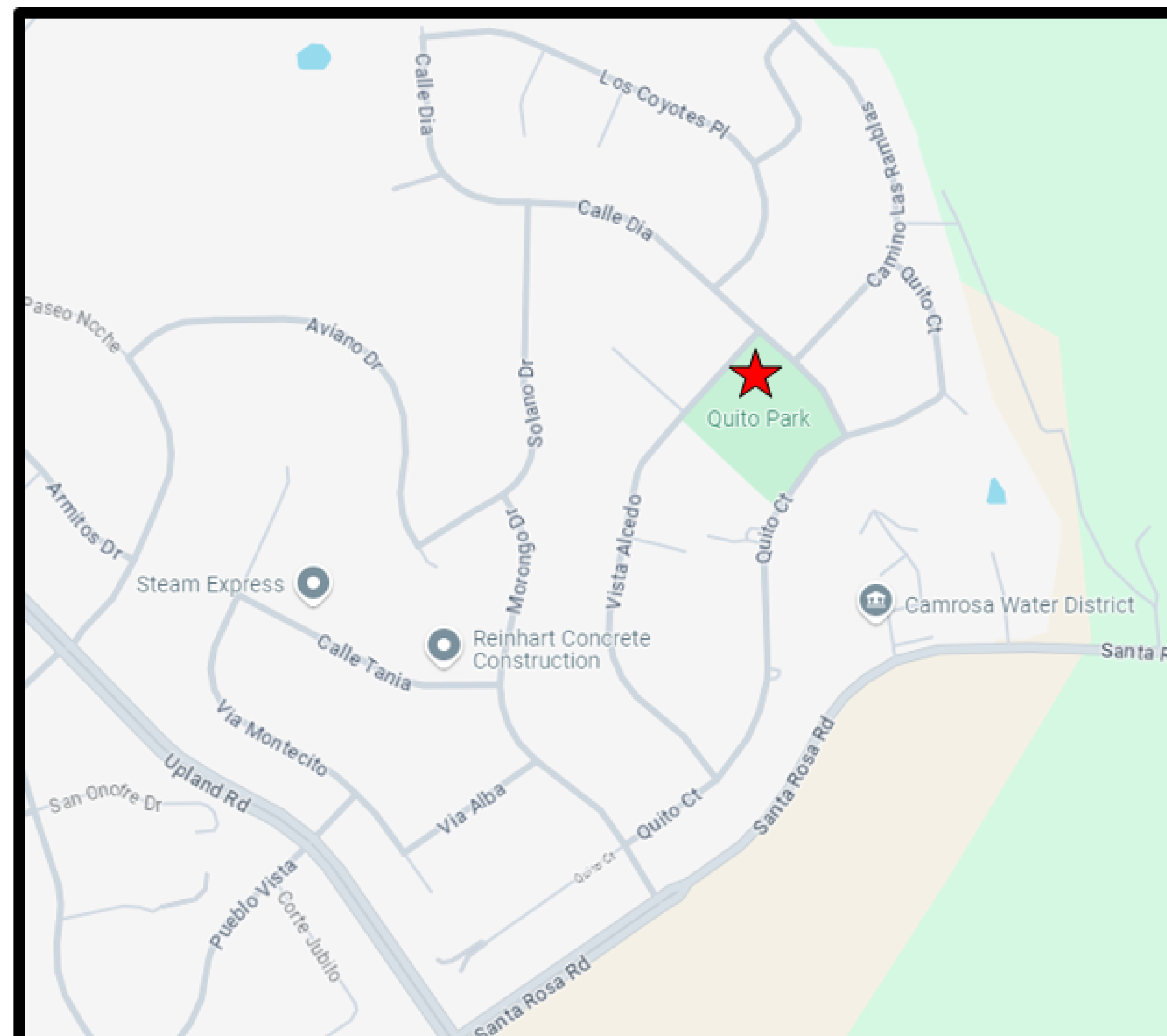

GENERAL DEMOLITION NOTES

1. PROTECT IN PLACE EXISTING TREES PER TREE PROTECTION NOTES THIS SHEET.
2. CONTRACTOR SHALL IMPLEMENT TEMPORARY PROJECT CONTROLS, INCLUDING PREPARATION AND MAINTENANCE OF BMPs AS REQUIRED. SEE TITLE SHEET.
3. CONTRACTOR IS RESPONSIBLE FOR REMOVAL OF ALL MATERIALS INDICATED ON PLANS.
4. ANY HAZARDOUS MATERIALS SHALL BE DISPOSED OF BY CONTRACTOR PRIOR TO GENERAL DEMOLITION.
5. UTILITY SHUTOFF SHALL BE COORDINATED BY CONTRACTOR, THE CITY OF THOUSAND OAKS AND DISTRICT.
6. WORK SHALL BE PERFORMED IN ACCORDANCE WITH CAL-OSHA CONSTRUCTION SAFETY ORDERS, MOST RECENT EDITION.
7. NO OPEN TRENCH SHALL BE LEFT EXPOSED WITHOUT FLAGMEN OR SECURITY GUARD.
8. NO OPEN EXCAVATION SUCH AS TRENCH OR PLANTING PIT GREATER THAN 4 INCHES DEEP WILL BE LEFT EXPOSED OR UNSECURED OVER NIGHT.
9. PROTECT IN PLACE EXISTING IMPROVEMENTS INCLUDING WALLS, PAVING, FENCING, PLANTING, IRRIGATION EQUIPMENT, VALVES, AND VALVE BOXES.
10. CONTRACTOR TO ESTABLISH INGRESS & EGRESS, & CONSTRUCTION ACCESS ROUTES TO LIMIT SITE DISTURBANCE

TREE PROTECTION NOTES

THESE TREE SPECIFICATIONS SHALL BE FOLLOWED TO PROTECT ALL TREES WHOSE DRIPLINE IS ENCRoACHED UPON EITHER DIRECTLY OR INDIRECTLY BY CONSTRUCTION.

A. GENERAL REQUIREMENTS

1. NO EQUIPMENT IS TO BE PARKED UNDER A TREE, NOR ARE ANY MATERIALS TO BE STORED WITHIN THE TREE'S DRIPLINE OR LEANED AGAINST A TREE TRUNK.
2. DO NOT PILE OR COMPACT SOIL WITHIN A DRIPLINE.
3. DO NOT NAIL GRADE STAKES OR ANYTHING ELSE TO TREES.
4. DO NOT STRIP TOPSOIL. ANY VEGETATION TO BE REMOVED SHOULD BE REMOVED BY CUTTING AT GROUND LEVEL RATHER THAN PULLING OUT BY EQUIPMENT.
5. USE OF PNEUMATIC DRILLS IS NOT PERMISSIBLE; EXCAVATION AROUND ROOTS MUST BE PERFORMED BY HAND ONLY, NO POWER TOOLS. CUT ANY ROOTS CLEANLY WITHOUT FRAYED OR SPLIT ENDS, AND SOIL BACKFILLED IMMEDIATELY.
6. ALL LANDSCAPE AREAS ARE TO RECEIVE UNINTERRUPTED IRRIGATION DURING ALL CONSTRUCTION.

B. TYPICAL WORK PROCEDURES

1. ALL WORK AROUND ANY EXISTING TREES SHALL FOLLOW THIS WORK PROCEDURES PROGRAM. THIS PROGRAM HAS BEEN DEVELOPED TO MINIMIZE IMPACTS TO EACH TREE AND PROTECT THEM FROM UNSCHEDULED DAMAGE.
2. ALL WORK WITHIN A TREE'S ROOT ZONE SHALL BE AS DIRECTED BY DISTRICT STAFF.
3. THE EXTENT OF ALL WORK AFFECTING ANY OAKS SHALL BE STAKED BY FIELD SURVEY AND REVIEWED WITH THE DISTRICT STAFF PRIOR TO IRRIGATION INSTALLATION.
4. HAND DIG VERTICAL TRENCH AT THE FINAL CUT LINE TO FINAL GRADE AND CLEANLY CUT ANY ROOTS ENCOUNTERED AND SEAL WITH APPROVED TREE SEAL.
5. NO FURTHER WORK WITHIN THE ROOT ZONE SHALL BE DONE BEYOND WHICH WAS APPROVED, WITHOUT OBTAINING WRITTEN APPROVAL FROM DISTRICT STAFF PRIOR TO PROCEEDING.

C. DAMAGES

1. IF A TREE, DESIGNATED TO REMAIN, IS REMOVED OR CAUSED TO BE IRREVERSIBLY DAMAGED AS DETERMINED BY DISTRICT STAFF, CONTRACTOR SHALL INSTALL A REPLACEMENT TREE MATCHING SIZE, QUALITY, AND VARIETY USING AN INSTALLER DESIGNATED BY THE DISTRICT. IF AN ACCEPTABLE REPLACEMENT TREE IS NOT AVAILABLE, CONTRACTOR WILL PAY DAMAGES TO THE DISTRICT FOR THE DAMAGED TREE VALUE AS ASSESSED BY THE TREE VALUE FORMULA IN ISA GUIDE FOR ESTABLISHING VALUE OF TREES AND OTHER PLANTS.

CONSTRUCTION AND GRADING GENERAL NOTES

1. ALL WORK SHALL CONFORM TO ALL CITY, COUNTY AND OTHER GOVERNING AGENCIES' REGULATIONS FOR CONSTRUCTION, GRADING AND DRAINAGE. CONTRACTOR SHALL OBTAIN ALL NECESSARY PERMITS, INSPECTIONS AND APPROVALS REQUIRED FOR THIS WORK.
2. FOR LOCATIONS OF EXISTING CONDITIONS, PROPERTY LINES, EASEMENTS, UTILITIES, ETC., REFER TO THE BOUNDARY AND TOPOGRAPHIC SURVEY. THE CONTRACTOR SHALL BE RESPONSIBLE FOR IDENTIFYING IN THE FIELD ALL PROPERTY LINES, EASEMENTS AND RESTRICTIONS IDENTIFIED ON THE PLANS.
3. THE CONTRACTOR SHALL BE RESPONSIBLE FOR THE ACCURATE LAYOUT OF THE PROJECT, FOR ESTABLISHING ALL REFERENCE POINTS, ELEVATIONS AND LINES SET FOR CONSTRUCTION, FOR CERTIFICATION OF FINISH GRADES AS SHOWN ON THE DRAWINGS, AND TO MATCH EXISTING SURFACES WHERE APPLICABLE. IF NEEDED, THE CONTRACTOR SHALL EMPLOY A REGISTERED CIVIL ENGINEER OR LICENSED LAND SURVEYOR IN ORDER TO ACCURATELY DETERMINE ALL HORIZONTAL AND VERTICAL DIMENSIONS.
4. CONTRACTOR SHALL VISIT THE SITE, VERIFY EXISTING CONDITIONS, BECOME FAMILIAR WITH EXISTING GRADES, SITE AND SOIL CONDITIONS.
5. THE CONTRACTOR SHALL NOTIFY THE DISTRICT OF ANY DISCREPANCIES BETWEEN THE ACTUAL SITE CONDITIONS AND THE PLANS PRIOR TO BEGINNING CONSTRUCTION.
6. WRITTEN DIMENSIONS SHALL PREVAIL OVER SCALED MEASUREMENTS ON THE PLANS AND DETAILS.
7. THE DISTRICT IS TO REVIEW AND APPROVE ALL LAYOUTS IN THE FIELD PRIOR TO THE START OF CONSTRUCTION.
8. VERIFY AND CLEARLY MARK THE LOCATION OF ALL UNDERGROUND UTILITIES AND SERVICES PRIOR TO ANY EXCAVATION. THE CONTRACTOR ASSUMES FULL RESPONSIBILITY FOR ALL DAMAGE CAUSED BY FAILURE TO DO SO.
9. DUST CONTROL AND EROSION & SILTATION PREVENTION SHALL BE IMPLEMENTED THROUGHOUT CONSTRUCTION AS REQUIRED BY THE GOVERNING AGENCIES, LOCAL CODES AND ORDINANCES.
10. CONTRACTOR SHALL KEEP THE SITE WATERED SUFFICIENTLY TO ELIMINATE DUST NUISANCE. SPECIMEN AND EXISTING TREES TO REMAIN SHALL BE WASHED DOWN WEEKLY TO HELP MAINTAIN THEIR HEALTH DURING CONSTRUCTION.
11. REPORT ANY CONDITIONS WHICH PREVENT PROPER EXECUTION OF THIS WORK TO THE DISTRICT.
12. THE CONTRACTOR SHALL BE RESPONSIBLE FOR PROTECTING FROM DAMAGE ALL STRUCTURES, UNDERGROUND UTILITIES AND ANY EXISTING PLANT MATERIAL IDENTIFIED TO REMAIN ON THE SITE.
13. NO BRANCHES, LIMBS OR ROOTS OF ANY PLANT MATERIAL ARE TO BE CUT OR PRUNED WITHOUT AUTHORIZATION AND DIRECTION FROM THE ARBORIST OR HORTICULTURALIST.
14. ALL PLANTING AREAS SHALL BE GRADED AT A MINIMUM OF 2% AWAY FROM STRUCTURES AND TOWARD APPROPRIATE DRAINAGE INLETS, UNLESS OTHERWISE NOTED ON PLANS. FINISH GRADES SHALL BE ONE (1) INCH BELOW ADJACENT PAVING IN LAWN AREAS, AND TWO (2) INCHES BELOW ADJACENT PAVING IN SHRUB/GROUND COVER AREAS.
15. NEW PAVING AREAS SHALL BE SET FLUSH TO EXISTING ADJACENT PAVING SURFACES. PAVING CROSS SLOPE SHALL BE MINIMUM OF 2%.
16. PAVING AREA DRAINAGE SHALL BE DIRECTED AWAY FROM BUILDINGS AND STRUCTURES AT A MINIMUM OF 2% FOR 5 FEET OR AS INDICATED ON THE DRAWINGS. ALL SURFACE FLOW SHALL BE DIRECTED TOWARD AND FLOW FREELY INTO DRAINAGE INLETS.
17. REFER TO PLAYGROUND MANUFACTURERS PLANS AND SPECIFICATION FOR FALL AND SAFETY ZONE. VERIFY ALL COMPONENTS AND SAFETY ZONE CONFORM TO ASTM F1487-11 AND STANDARD CONSUMER SAFETY PERFORMANCE SPECIFICATIONS FOR PLAYGROUND EQUIPMENT FOR PUBLIC USE CAN/CSA-Z614-07 - CHILDREN'S PLAYSPACES AND EQUIPMENT PRIOR TO PURCHASE AND INSTALLATION.
18. FINE GRADED SUBGRADE DRAINAGE SHALL BE 2% MINIMUM. FINE GRADING AROUND PLAY STRUCTURES SHALL DRAIN AWAY FROM FOOTINGS, TO THE DISTRICT'S SATISFACTION.
19. REPAIR AND REPLACE ANY EXISTING IMPROVEMENTS DAMAGED DURING CONSTRUCTION TO PRE-CONSTRUCTION CONDITION TO DISTRICT'S SATISFACTION. THIS INCLUDES ANY TURF AREAS ADJACENT TO WORK AND THROUGHOUT THE PROPERTY. ANY DAMAGED TURF AREAS TO BE REPLACED WITH SOD, TYPE PER DISTRICT'S SPECIFICATION AND FENCED FOR A MINIMUM OF 5 WEEKS FOR ESTABLISHMENT PERIOD.

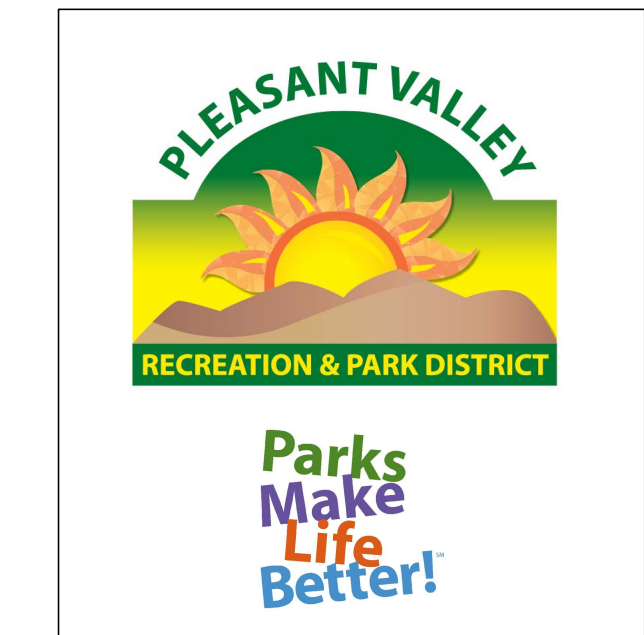

OWNER
PLEASANT VALLEY RECREATION AND PARK DISTRICT
 1605 EAST BURNLEY ST. CAMARILLO CA. 93010

Construction Details and General Notes

PROJECT
QUITO PARK PLAYGROUND INSTALLATION

REVISIONS		
NO.	REVISIONS/ISSUE	DATE
1	DESCRIPTION	DATE

ISSUED FOR: BID	DATE OCT. .202
DRAWN / CHECKED	
SCALE N.T.S.	PROJECT NO. QUITO-PG-25
SHEET	

L-2



IMPORTANT NOTE:
 NO EXCAVATION OF ANY KIND IS TO OCCUR ANYWHERE ON SITE WITHOUT FIRST VERIFYING THE LOCATIONS OF EXISTING UNDERGROUND UTILITIES.

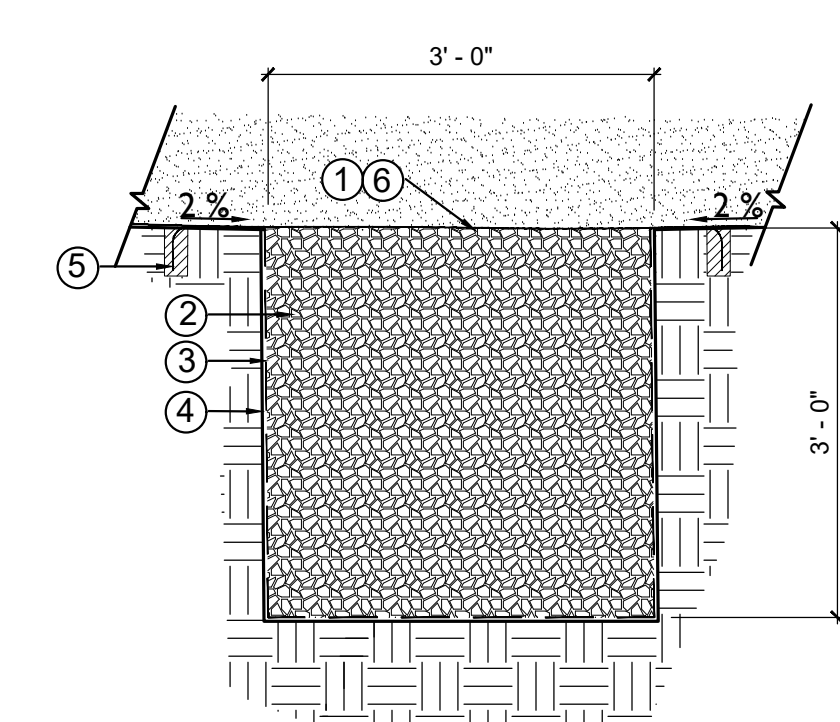

1. 14" DEEP ENGINEERED WOOD FIBER (EWF) IN PLAY AREA. INSTALL ACCORDING TO MANUFACTURER'S INSTRUCTIONS
2. 3/4 -INCH CLEAN CRUSHED GRAVEL
3. GEOTEXTILE SEPARATION FABRIC, TENCATE MIRAFI NL OR APPROVED EQUAL, TO ALLOW DRAINAGE, FILTRATION AND SEPARATION BETWEEN:
 - ENGINEERED WOOD FIBER AND EARTH.
 - PIT GRAVEL AND EARTH.
 - ENGINEERED WOOD FIBER AND SUMP GRAVEL.
4. SUMP WALL OR UNDISTURBED SUBGRADE, NATIVE SOIL.
5. GEOTEXTILE ANCHOR - BURY END OF GEOTEXTILE MIN 8 INCHES INTO COMPACTED SOIL.
6. GEOTEXTILE SEPARATOR INSTALL ON SUBGRADE BELOW EWF. ANCHOR ACCORDING TO MANUFACTURER'S INSTRUCTIONS.

A DRAINAGE PIT AT PLAYGROUND

NOT TO SCALE

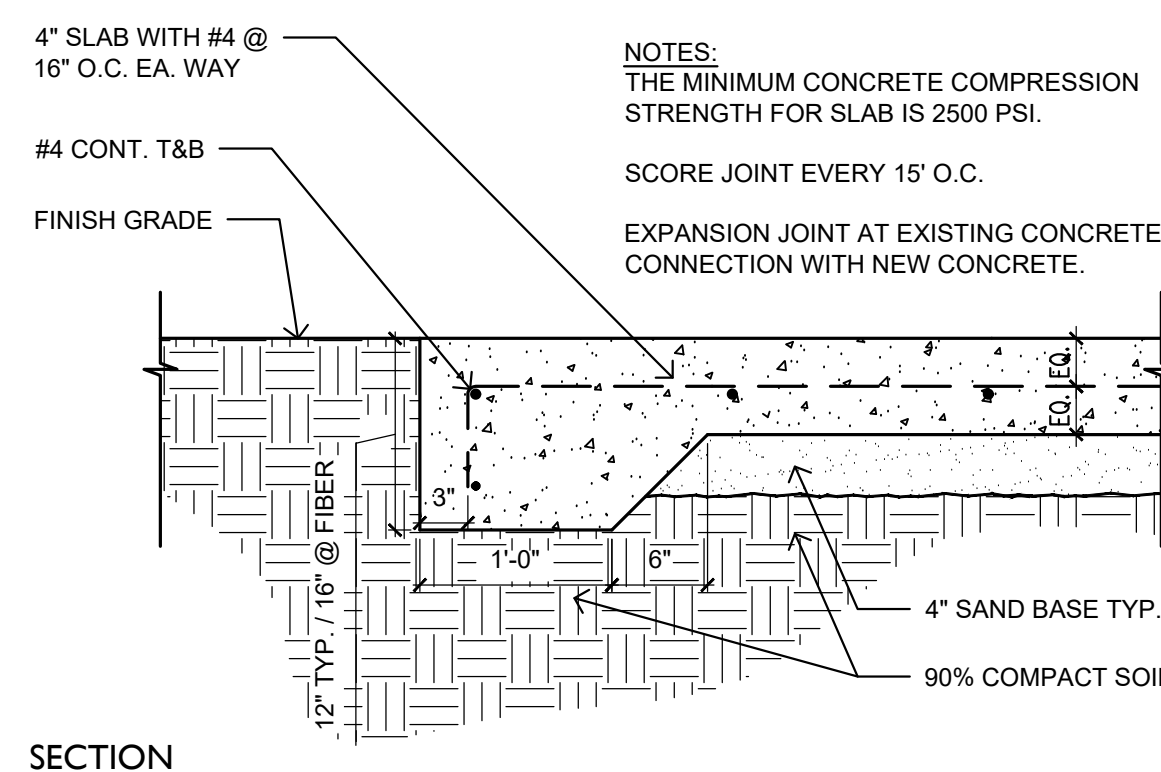

SECTION

B CONCRETE PAVING

SCALE: 1" = 1'-0"

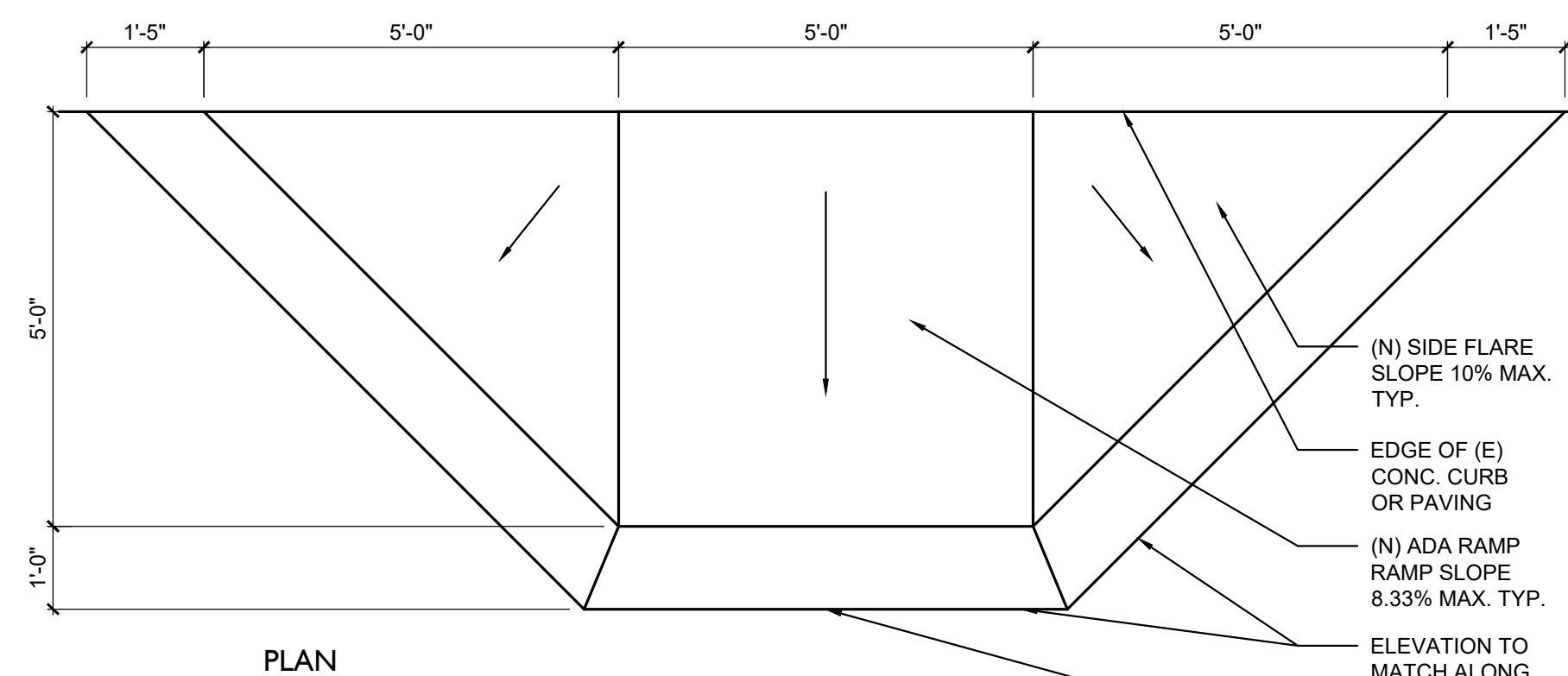

PLAN

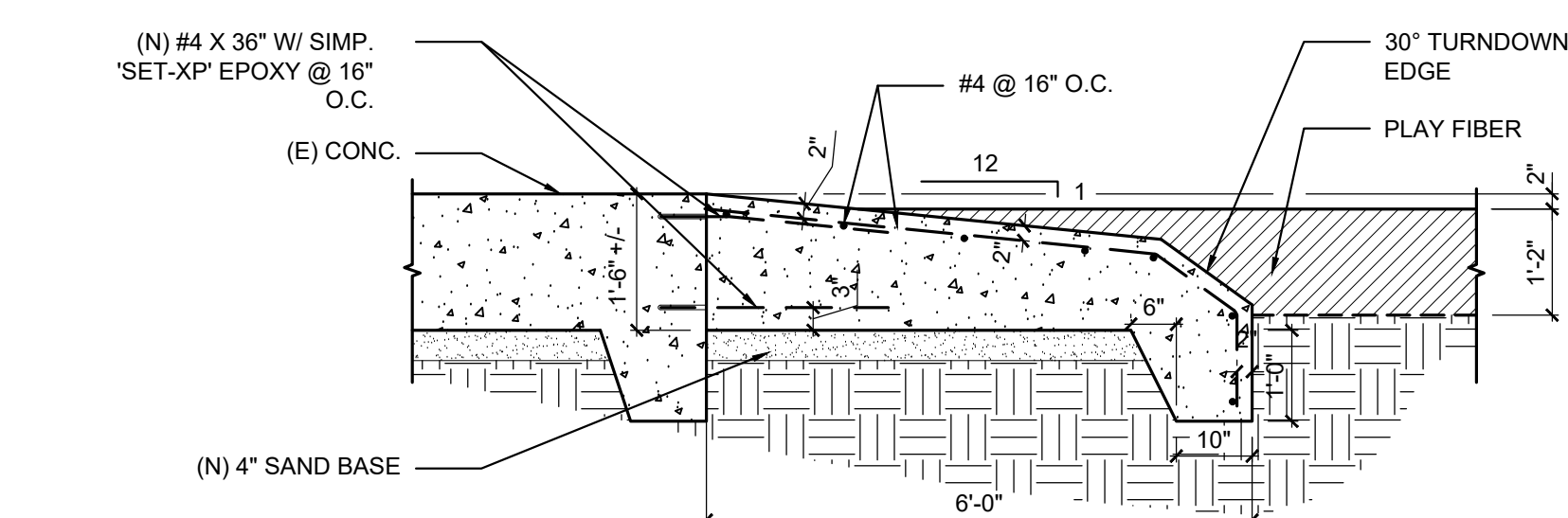

SECTION

C ADA CONCRETE RAMP AT PLAYGROUND

SCALE: 1/2" = 1'-0"

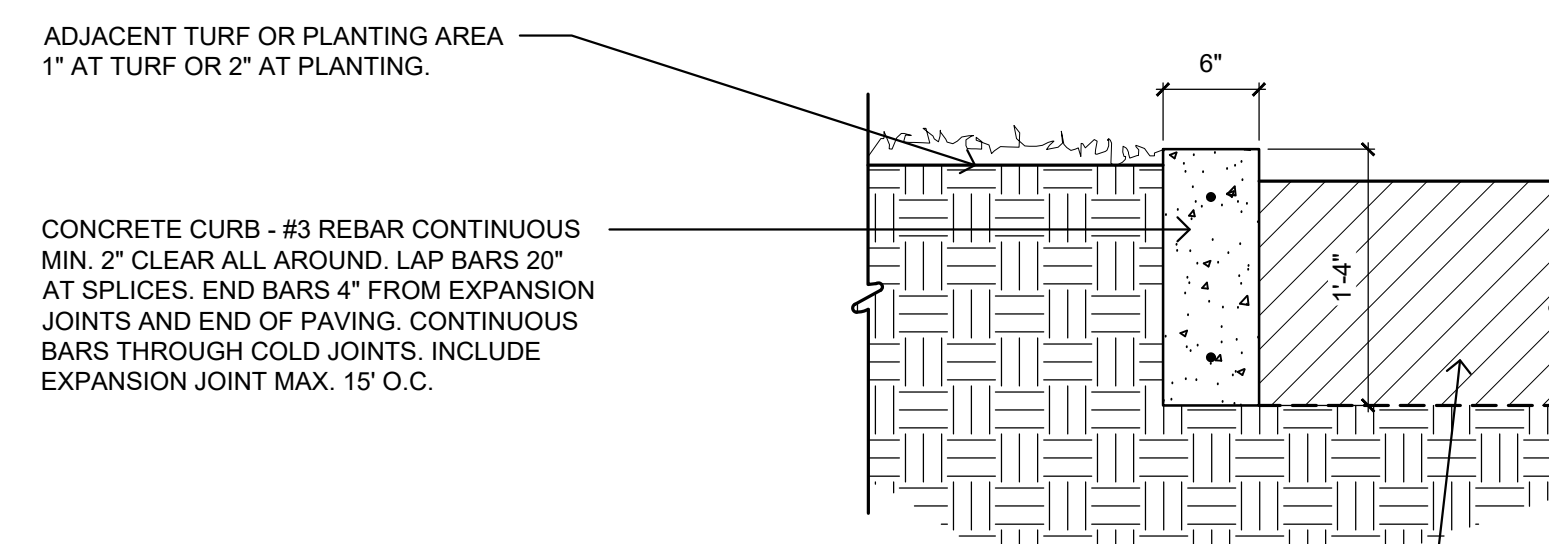

SECTION

D CONCRETE CURB

SCALE: 1" = 1'-0"



IMPORTANT NOTE:
 NO EXCAVATION OF ANY KIND IS TO OCCUR ANYWHERE ON SITE WITHOUT FIRST VERIFYING THE LOCATIONS OF EXISTING UNDERGROUND UTILITIES.

Quito Park
1605 Burnley St
Camarillo CA 93010

Play and Park Structures

This play equipment is recommended for children ages: 2-5 or 5-12
Minimum Area Required: 102'-11" x 44'-0"

Scale: 1/8" = 1'-0"
This drawing can be scaled only when in an 11" x 17" format

Drawn By: Tiffanie Brown
Date: 9/10/24
Quote Number: 821-170590A

play&park structures
A PLAYCORE Company
544 Chestnut Street
Chattanooga, TN 37402
800-727-1907 / www.playandpark.com

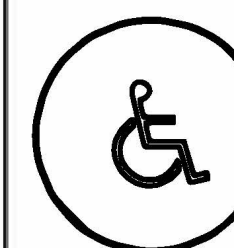

Total Play Components: 14
Elevated Play Components: 7
Elevated Play Components Accessible by Ramp: 0
Elevated Components Accessible by Transfer: 7
Accessible Ground Level Components Shown: 3
Different Types of Ground Level Components: 4

User Capacity: 45-55
Critical Fall Height: 8'-0"

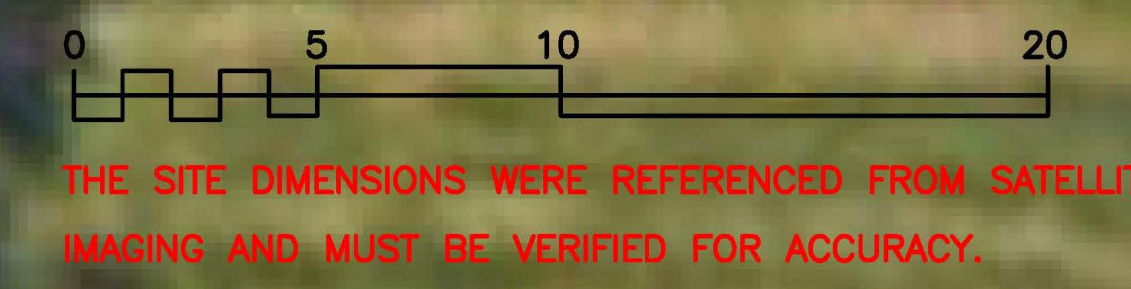
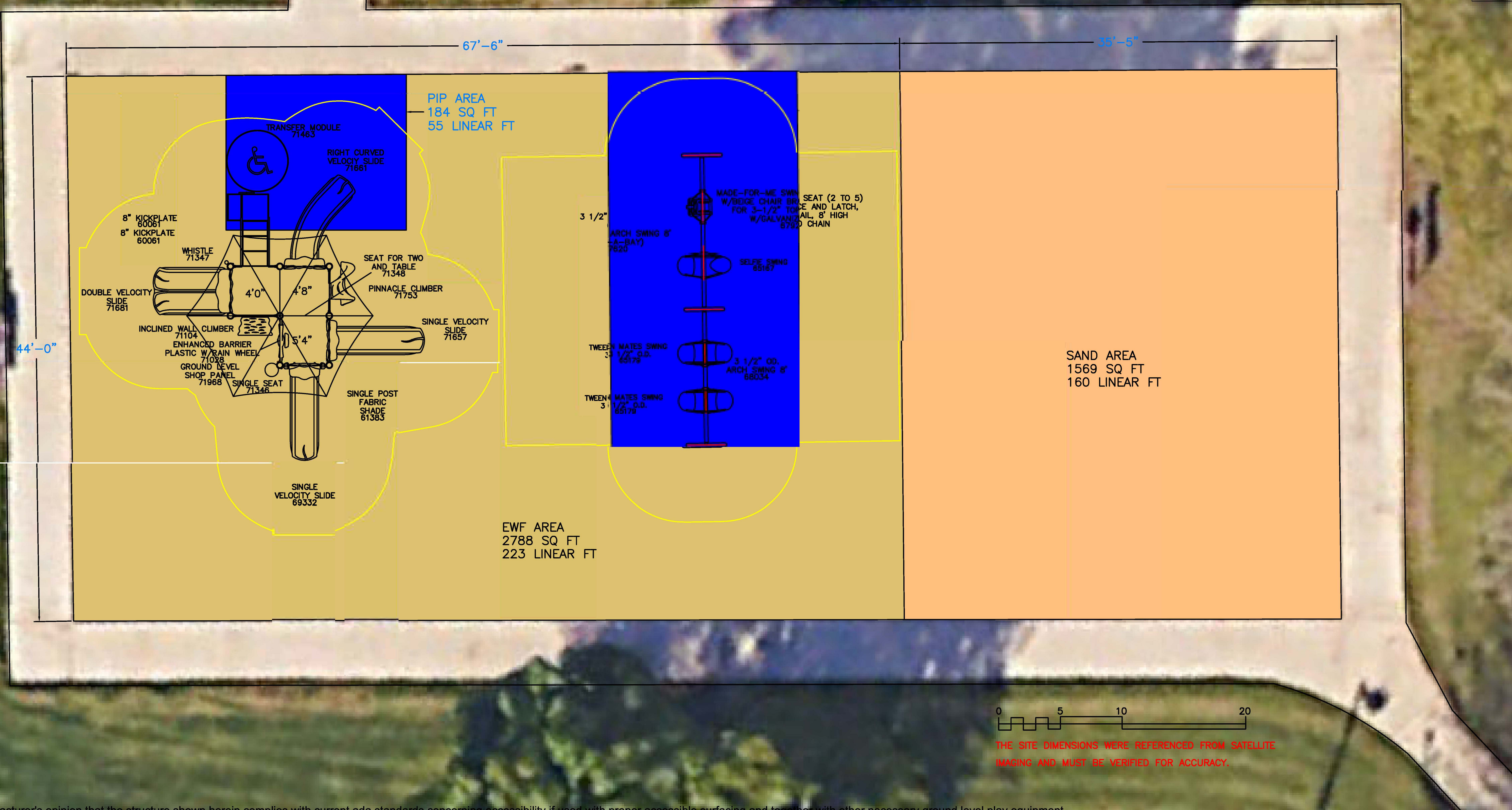

It is the manufacturer's opinion that the structure shown herein complies with current ada standards concerning accessibility if used with proper accessible surfacing and together with other necessary ground level play equipment.
Top View drawings and measurements are for overall site and structure appearance purposes. Top view should not be conceived as a construction detail; therefore, all measurements and slope requirements should be field verified prior to construction.
IMPORTANT: Never install play equipment over hard, unresilient surfaces such as asphalt, concrete, or compacted earth. It is the owner's responsibility to ensure the "minimum area required" contains an appropriate amount of resilient material to cushion accidental falls.



OWNER
PLEASANT VALLEY
RECREATION AND PARK DISTRICT
1605 EAST BURNLEY ST. CAMARILLO CA. 93010

PROJECT
QUITO PARK
PLAYGROUND INSTALLATION

REVISIONS		
NO.	REVISIONS/ISSUE	DATE
1	DESCRIPTION	DATE

ISSUED FOR: BID
DATE: OCT. .202

DRAWN / CHECKED

SCALE: N.T.S.
PROJECT NO.: QUITO-PG-25

SHEET



Parks Make Life Better!

Quito Park Option 2
1605 Burnley St
Camarillo CA 93010

This play equipment is recommended for children ages:
5-12

Scale: 1/8" = 1'-0"
This drawing can be scaled only when in an 11" x 17" format

Drawn By:
Tiffanie Brown
Date:
9/13/24
Quote Number:
821-170591B

play&park structures
A PLAYCORE Company
544 Chestnut Street
Chattanooga, TN 37402
800-727-1907 / www.playandpark.com

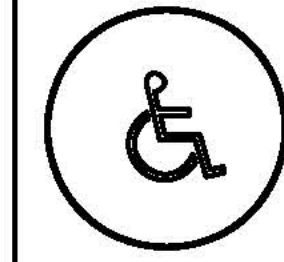

Total Play Components	16
Elevated Play Components	8
Elevated Play Components Accessible by Ramp	0 Req. 0
Elevated Components Accessible by Transfer	8 Req. 4
Accessible Ground Level Components Shown	8 Req. 3
Different Types of Ground Level Components	5 Req. 3

User Capacity	75-85
Critical Fall Height	8'-0"

Play and Park Structures

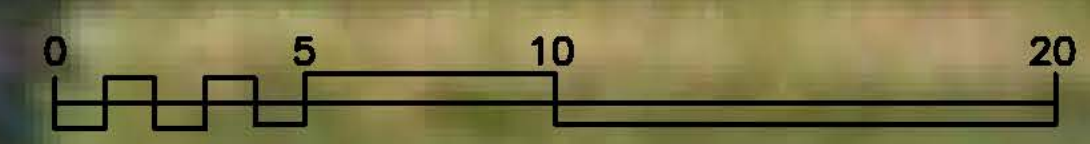
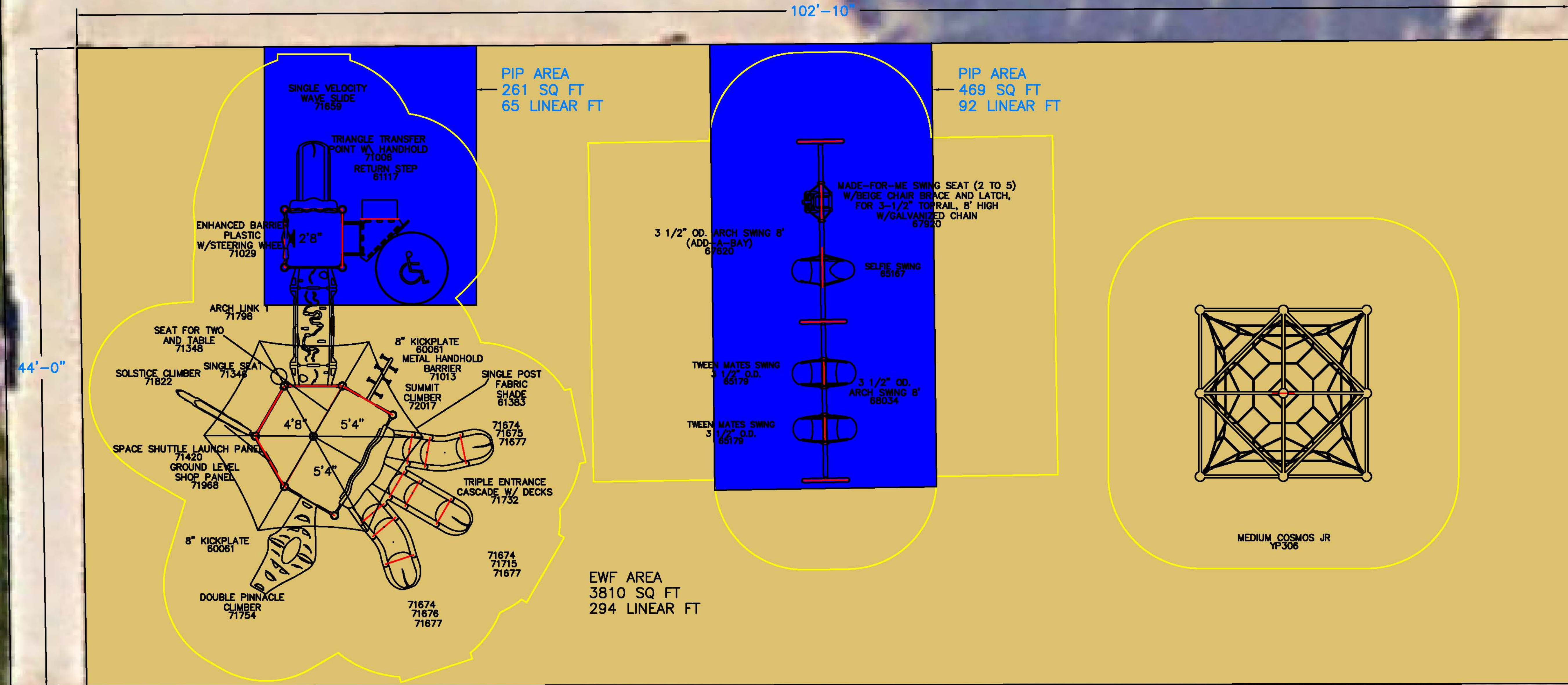

THE SITE DIMENSIONS WERE REFERENCED FROM SATELLITE IMAGING AND MUST BE VERIFIED FOR ACCURACY.

It is the manufacturer's opinion that the structure shown herein complies with current ada standards concerning accessibility if used with proper accessible surfacing and together with other necessary ground level play equipment. Top View drawings and measurements are for overall site and structure appearance purposes. Top view should not be conceived as a construction detail; therefore, all measurements and slope requirements should be field verified prior to construction. **IMPORTANT:** Never install play equipment over hard, unresilient surfaces such as asphalt, concrete, or compacted earth. It is the owner's responsibility to ensure the "minimum area required" contains an appropriate amount of resilient material to cushion accidental falls.

OWNER
PLEASANT VALLEY
RECREATION AND PARK DISTRICT
1605 EAST BURNLEY ST. CAMARILLO CA. 93010

PROJECT
QUITO PARK
PLAYGROUND INSTALLATION

REVISIONS		
NO.	REVISIONS/ISSUE	DATE
1	DESCRIPTION	DATE

ISSUED FOR:	DATE
BID	OCT. .202
DRAWN / CHECKED	
SCALE	PROJECT NO.
N.T.S.	QUITO-PG-25
SHEET	

DRAINAGE AND CURBING LAYOUT



Quito Park Option 1 1605 Burnley St Camarillo CA 93010 Play and Park Structures	This play equipment is recommended for children ages: 2-5 or 5-12	Scale: 1/8" = 1'-0" This drawing can be scaled only when in an 11" x 17" format	Drawn By: Tiffanie Brown Date: 9/10/24 Quote Number: 821-170590A	A PLAYCORE Company 544 Chestnut Street Chattanooga, TN 37402 800-727-1907 / www.playandpark.com		Total Play Components: 14 Elevated Play Components: 7 Elevated Play Components Accessible by Ramp: 0 Elevated Components Accessible by Transfer: 7 Accessible Ground Level Components Shown: 3 Different Types of Ground Level Components: 4	User Capacity: 45-55 Critical Fall Height: 8'-0"
	Minimum Area Required: 102'-11" x 44'-0"	Req. 0 Req. 4 Req. 2 Req. 2					

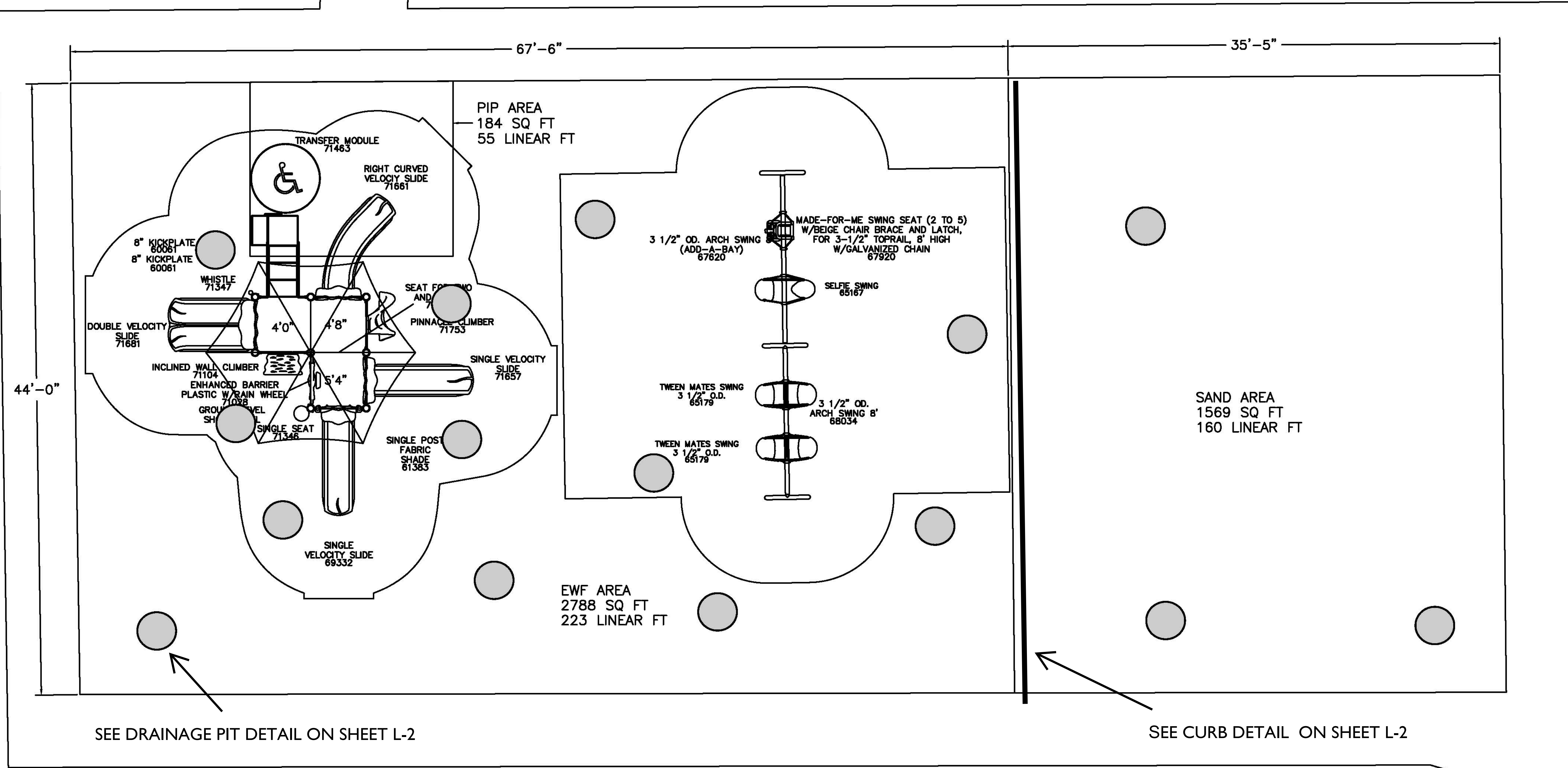

SEE DRAINAGE PIT DETAIL ON SHEET L-2

SEE CURB DETAIL ON SHEET L-2

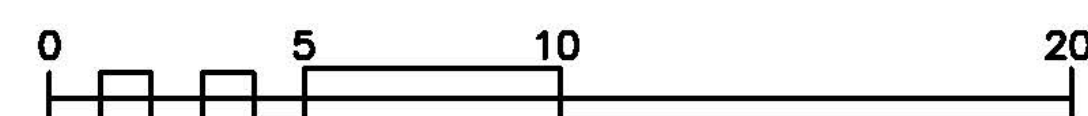

THE SITE DIMENSIONS WERE REFERENCED FROM SATELLITE IMAGING AND MUST BE VERIFIED FOR ACCURACY.

It is the manufacturer's opinion that the structure shown herein complies with current ada standards concerning accessibility if used with proper accessible surfacing and together with other necessary ground level play equipment. Top View drawings and measurements are for overall site and structure appearance purposes. Top view should not be conceived as a construction detail; therefore, all measurements and slope requirements should be field verified prior to construction. **IMPORTANT:** Never install play equipment over hard, unresilient surfaces such as asphalt, concrete, or compacted earth. It is the owner's responsibility to ensure the "minimum area required" contains an appropriate amount of resilient material to cushion accidental falls.

OWNER
 PLEASANT VALLEY
 RECREATION AND PARK DISTRICT
 1605 EAST BURNLEY ST. CAMARILLO CA. 93010

DRAINAGE PIT LAYOUT

PROJECT
 QUITO PARK
 PLAYGROUND INSTALLATION

REVISIONS		
NO.	REVISIONS/ISSUE	DATE
1	DESCRIPTION	DATE

ISSUED FOR: BID	DATE OCT. 2022
DRAWN / CHECKED	
SCALE N.T.S.	PROJECT NO. CALLEGUAS-PG-25
SHEET	

L-5

DRAINAGE LAYOUT



Quito Park Option 2
1605 Burnley St
Camarillo CA 93010

This play equipment is recommended for children ages: 5-12
Minimum Area Required: 102'-10" x 44'-0"

Scale: 1/8" = 1'-0"
This drawing can be scaled only when in an 11" x 17" format

Drawn By: Tiffanie Brown
Date: 9/13/24
Quote Number: 821-170591B

play&park structures
A PLAYCORE Company
544 Chestnut Street
Chattanooga, TN 37402
800-727-1907 / www.playandpark.com

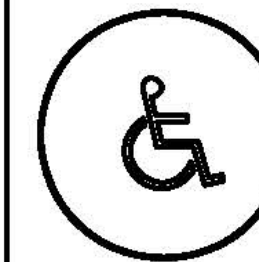

Total Play Components	16
Elevated Play Components	8
Elevated Play Components Accessible by Ramp	0 Req. 0
Elevated Components Accessible by Transfer	8 Req. 4
Accessible Ground Level Components Shown	8 Req. 3
Different Types of Ground Level Components	5 Req. 3

<u>User Capacity</u>	75-85
<u>Critical Fall Height</u>	8'-0"

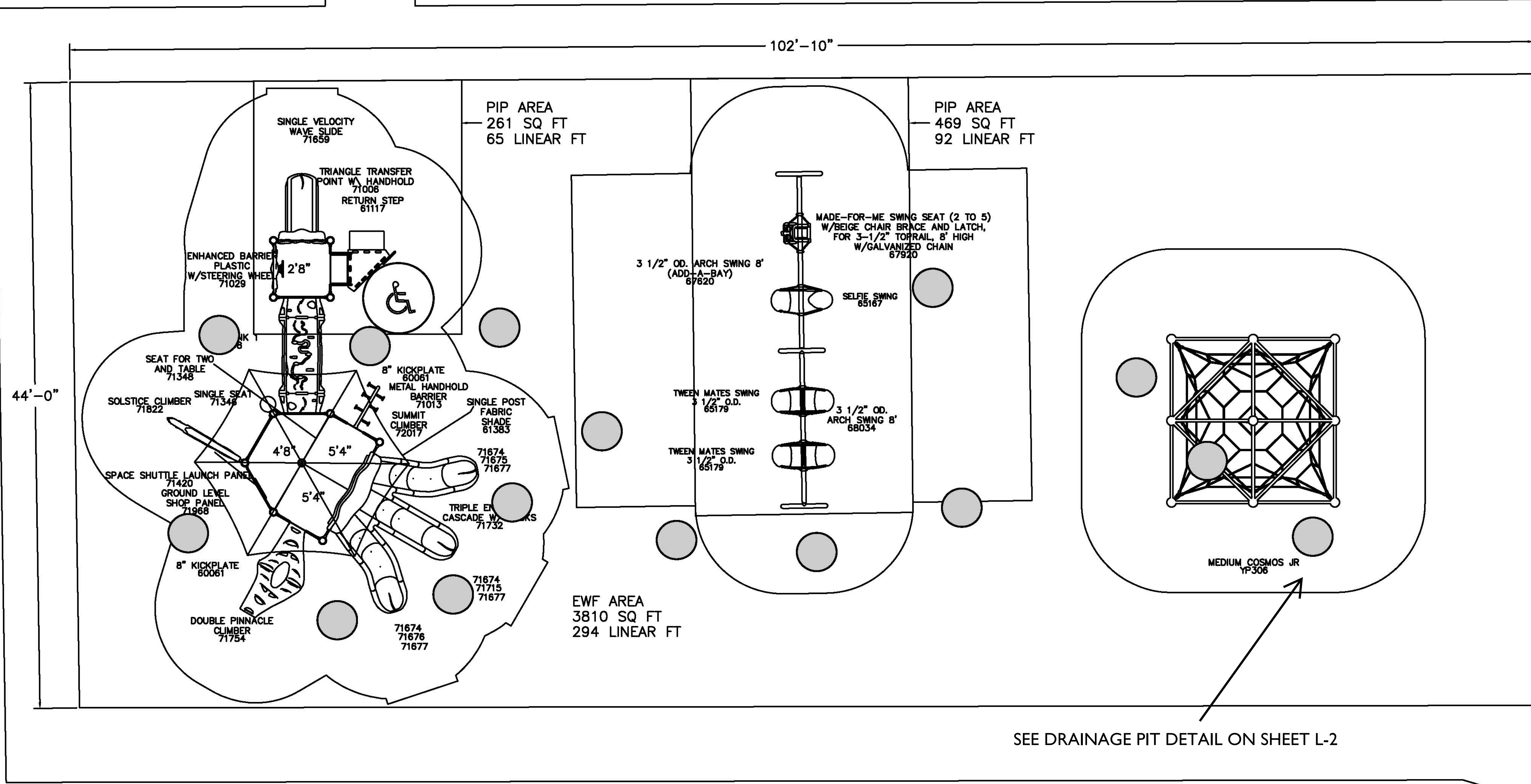

SEE DRAINAGE PIT DETAIL ON SHEET L-2

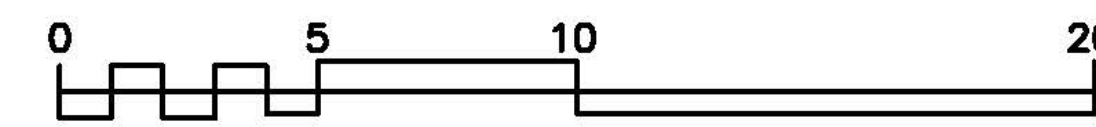

THE SITE DIMENSIONS WERE REFERENCED FROM SATELLITE IMAGING AND MUST BE VERIFIED FOR ACCURACY.

It is the manufacturer's opinion that the structure shown herein complies with current ada standards concerning accessibility if used with proper accessible surfacing and together with other necessary ground level play equipment.
Top View drawings and measurements are for overall site and structure appearance purposes. Top view should not be conceived as a construction detail; therefore, all measurements and slope requirements should be field verified prior to construction.
IMPORTANT: Never install play equipment over hard, unresilient surfaces such as asphalt, concrete, or compacted earth. It is the owner's responsibility to ensure the "minimum area required" contains an appropriate amount of resilient material to cushion accidental falls.

OWNER
PLEASANT VALLEY
RECREATION AND PARK DISTRICT
1605 EAST BURNLEY ST. CAMARILLO CA. 93010

PROJECT
QUITO PARK
PLAYGROUND INSTALLATION

REVISIONS		
NO.	REVISIONS/ISSUE	DATE
1	DESCRIPTION	DATE

ISSUED FOR: BID	DATE OCT. .202
DRAWN / CHECKED	
SCALE N.T.S.	PROJECT NO. QUITO-PG-25
SHEET	

L-6